

Tube Dimensions

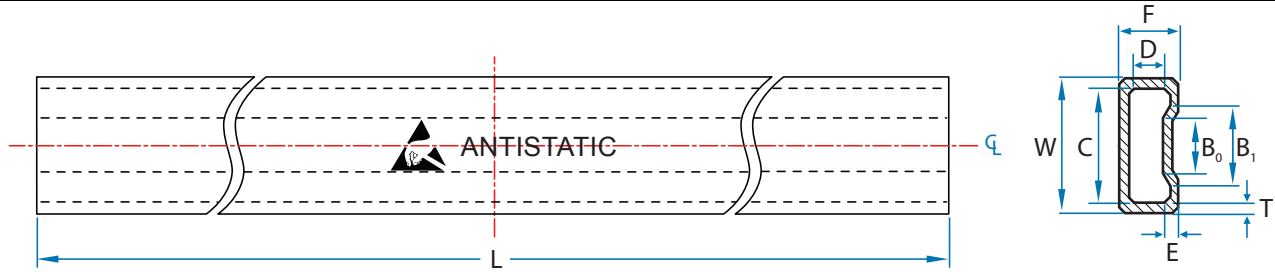

NOTES:

1. Printing is located at center of tube.
2. Tube color is clear; printing is blue.
3. Antistatic tube to have surface resistivity between 10^5 and 10^{12} Ohms per square.
4. Pin one orientation is down left when white plug is at left side of tube.

Pin count	Package	Parts/ Tube	Tube Dimensions (mm)								
			L	W	C	F	D	E	B ₀	B ₁	T
14	SOIC 14-Pin	56 (max)	520.700	7.899	6.858	4.064	2.235	1.397	3.048	4.699	0.533

End Plug/Pin Specifications

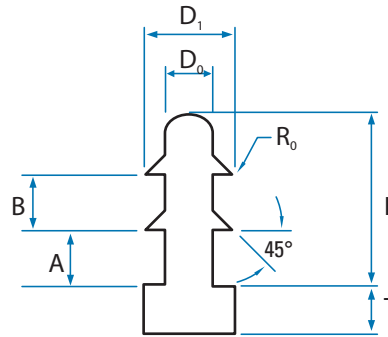
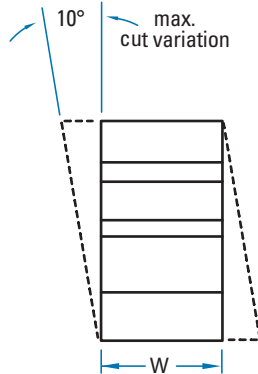

NOTES:

1. Drawing not to scale.
2. Straightness TIR 0.762mm max.
3. Color: White and Black

End Plug Dimensions (mm)

W	A	B	D ₀	D ₁	R ₀	L	T
4.445	2.032	2.032	1.778	3.429	0.127	6.350	1.778

Pin 1 Orientation

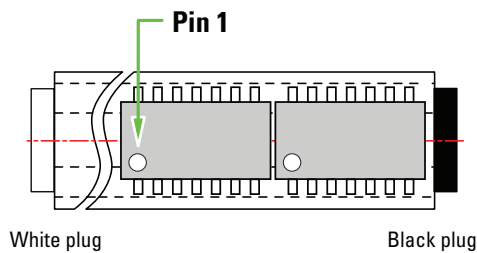

Typical Label Specifications

RAMTRON

- 1 FMxxxx-G
- 2 LOT80821G1
- 3 QTY 370
- 4 DATE CODE 0826
- 5 COUNTRY OF ORIGIN - THAILAND



Minimum label information

1. Product number
2. Lot number (max. 1 lot per tube)
3. Part quantity
4. Date code
5. Country of origin
6. UL Recognized Component mark with adjacent UL file number (*Processor companion parts only*)